

Oblue Baby Shower System Installation Instructions

Parts Included

Shower head, Hose with two black washers, Shower diverter, Faucet aerator, Universal sink adaptor

Tools Required

Adjustable Wrench, Sealing Teflon Tape

Warning. Child should never be left alone while bathing and always be at arms length to prevent drowning. This shower does not regulate or monitor water temperature. Always check water temperature after turning the shower on.

Assemble Baby Shower

- Insert black washers into the plastic nuts on both sides top of the hose..
- Screw on Shower Head onto one end of the hose



Attaching Baby Shower to Sink Faucet

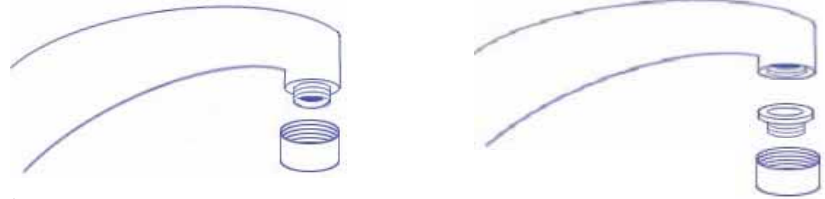

- Screw off the existing aerator from your faucet, use pliers if you need to.
- Check if your faucet has threads on the outside, then the Baby Shower aerator should screw right on
- If faucet has threads on the inside then screw on universal adaptor first onto the faucet. Then screw on the Baby Shower aerator onto the universal adaptor. Make sure black washers are inside universal adaptor and aerator before attaching.
- Screw on Baby Shower onto faucet aerator

Attaching Baby Shower to Shower

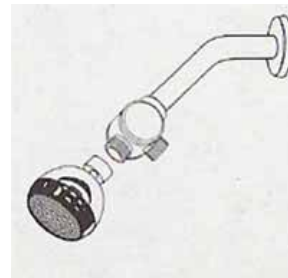
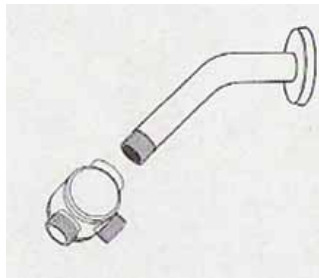

- Remove old shower head. Clean threads. If old shower arm has a ball where shower head connects to arm replace with shower arm with threads on both ends
- Apply thread seal tape to shower arm thread. Screw on diverter valve. Tighten firmly.
- Using thread seal tape reinstall showerhead.
- Screw on Baby Shower onto diverter.